



Barlinek

NEXT STEP

modern vinyl floors

INSTALLATION INSTRUCTIONS NEXT STEP LVT (SPC CLICK)



perfect imitation of nature

1. INTRODUCTION

The **SPC LVT** floors designed by Barlinek as the **MODERN NEXT STEP VINYL FLOORING** collection are intended for both, floating and glue down (in exceptional situations) indoor installation.

2. BEFORE INSTALLATION

Storage

NEXT STEP LVT floors must be stored on a flat surface, in a dry and ventilated area. Do not store the panels in cold (below 0°C), very hot (above 35°C) and humid areas. ¹

Checks before installation:

Despite the utmost care during production, it is recommended to inspect the panels before installation. Check the conformity of batch numbers, colour, patterns, dimensions and for presence of visible damage to avoid installing panels with defects. ²

BARLINEK S.A. recommends to install panels from one production batch in one room. ³

If you notice any of these issues do not proceed with the installation and contact your dealer for further instructions. ⁴

Acclimatisation:

NEXT STEP LVT floors require no special acclimatisation. However, **BARLINEK S.A.** recommends to leave the panels at a constant room temperature (18°C – 29°C) for 24 hours to ensure that the panel temperature equalises with that of the room and guarantee optimal panel parameters for installation. ⁵

Do expose the LVT panels to sudden temperature changes during installation (e.g. delivery in freezing weather to a heated room and proceeding with the installation without acclimatisation time) .

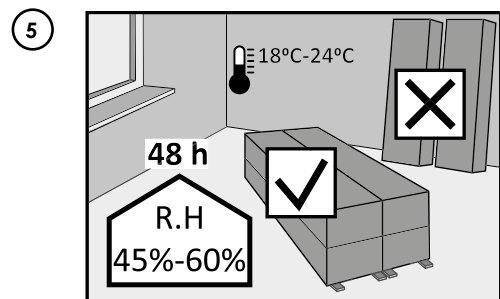
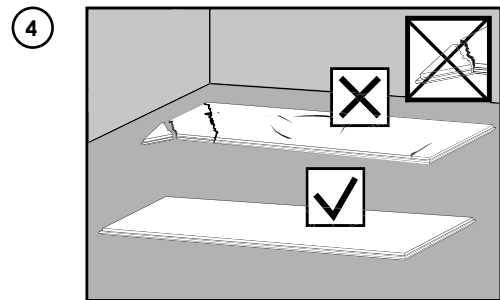
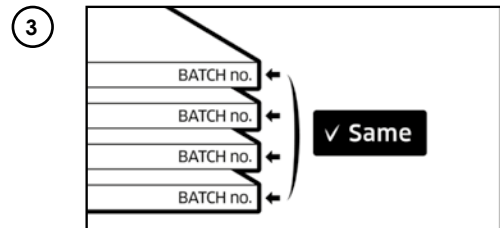
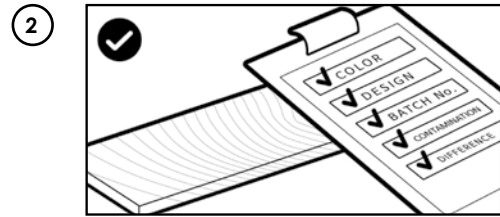
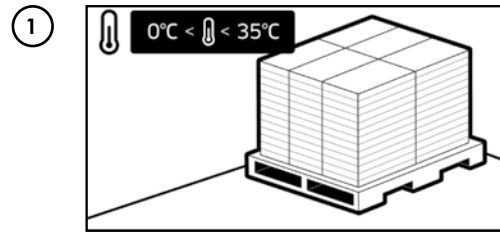

3. NEXT STEP FLOOR UNDERLAYMENT

For floating installation of the **NEXT STEP LVT**, additional sound absorbing underlayment must be used. Use the dedicated **BARLINEK's Next Step EXTREME 1.5** underlayment to keep full warranty rights. ⁶

The **NEXT STEP VINYL FLOORS** require the subfloor to be levelled up to 5 mm difference for a 2 m batten. When installing the Next Step vinyl floors in public areas with heavy traffic, it is recommended to level the subfloor with levelling compounds. ⁷

Larger cracks and damage to the screed must be repaired before installation. ⁸

The table to the right indicates the allowable deviations and imperfections of various substrates when installing the **NEXT STEP LVT**.

If the table does not refer to your specific flooring product contact your dealer or **BARLINEK's** Technical Department.

Subfloor type	Installation possible
Cement screed	YES – maximum difference of 5 mm on 2 m battens
Anhydrite screed	YES – maximum difference of 5 mm on 2 m battens
Ceramic tiles, stone, marble (not jointed)	YES – maximum joint size: 7 mm wide/2 mm deep/ 2 mm offset between tiles
Compact PVC floor coverings (heterogeneous, homogeneous, linoleum)	YES – if the damaged area does not exceed 10% of the surface area. Local dents must be filled in.
Resin and painted floors	YES – if the damaged area does not exceed 10% of the surface area. Local dents must be filled in.
Floating floors	NO – the old flooring must be removed before installation
Carpet flooring	NO – the old flooring must be removed before installation
Outdoors	INSTALLATION NOT ALLOWED

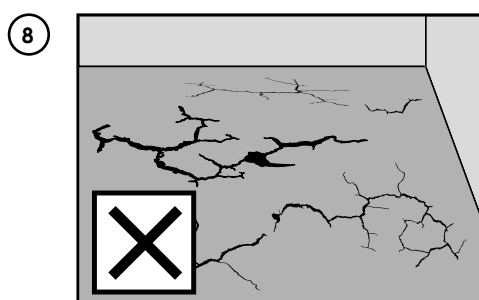
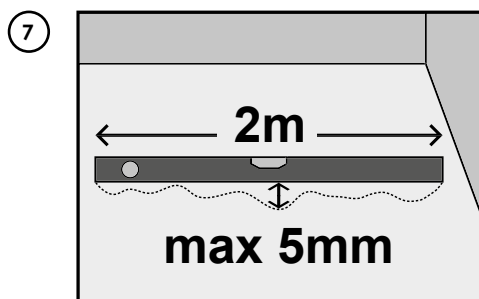
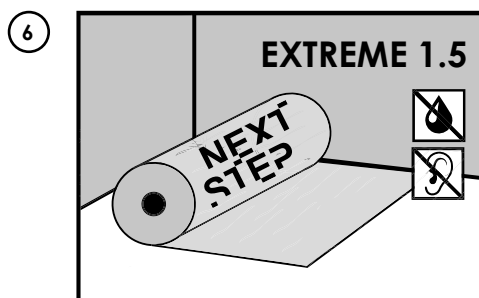

4. SUBSTRATE MOISTURE CONTENT

NEXT STEP LVT is a generally moisture resistant product. BARLINEK S.A. recommends to follow the rules of building and flooring installation and guidelines of the Building Research Institute to avoid the development of bacteria and mould under panels in use:

The installation site should be adequately heated and dried.

The substrate moisture content must be measured in at least 5 different points and the moisture level should be below 2% CM (for cement screed) and 0.5% CM (for anhydrite screed).⁹

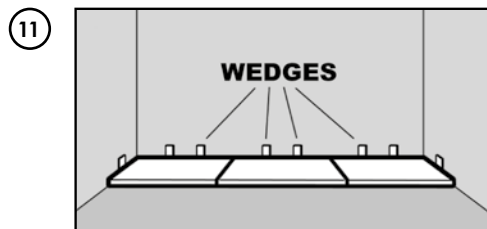
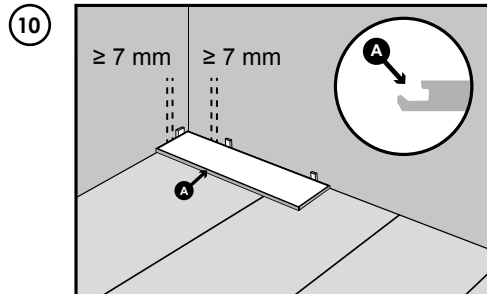
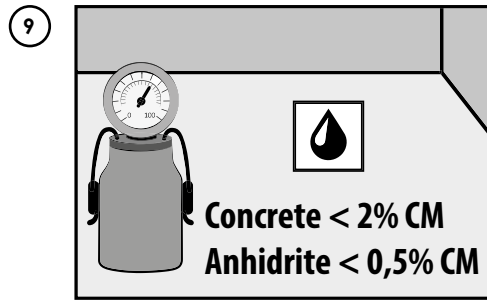

5. GENERAL INSTALLATION INSTRUCTIONS

Perimeter expansion gap

Compared to other PVC based panels, the **NEXT STEP LVT** floors maintain dimensional stability, both at low and high temperatures. However, perimeter expansion gaps are required. Check the entire installation area of the floor and make sure that the dimensions of the entire area allow for a minimum expansion gap of approx. 7-10 mm at each wall. In case of installation in places exposed to intense sunlight, e.g. with large glazing, a larger expansion gap should be used along the wall line of such glazing, up to 15 mm wide.¹⁰

To achieve the correct expansion gap width, use wedges which should be removed after the floor installation is finished.¹¹

The perimeter expansion gap should be left around any type of obstacles or elements such as pipes, columns, door frames, fixed furniture, etc.

SEPARATING EXPANSION GAPS

The surface area of the NEXT STEP LVT floor in case of the floating installation, should not exceed 200 m². Otherwise, and if any side of the installed floor exceeds 15 m in length (for floors installed without threshold expansion gap, sides of the entire installation area are considered), a 10 mm wide separating expansion gap and/or threshold gaps should be provided (depending on the room layout and thermal conditions).¹²

In the case of **NEXT STEP LVT** floor installation in rooms with and without underfloor heating, it is necessary to provide an expansion gap of 10 mm between the room/area with and without underfloor heating, except for the glue down installation on the entire area.

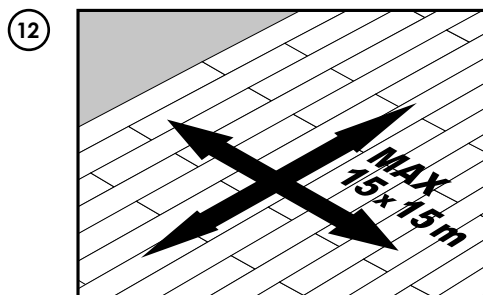
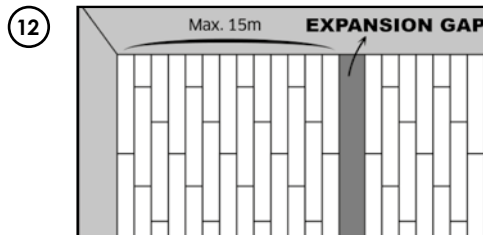

6. INSTALLATION – INTRODUCTION

IMPORTANT: IN CASE OF THE FLOATING INSTALLATION, THE NEXT STEP LVT SHOULD NOT BE ATTACHED TO THE SUBFLOOR, WALLS OR OTHER FIXED ELEMENTS.

Fixed furniture (e.g. cupboards or wardrobes) should be installed before the floor, or these elements should be separated from the floor with expansion gaps. The only exception is when the unit weight of the fixed furniture does not exceed 300 kg (equal load), or the point load (legs) does not exceed 150 kg per one leg (e.g. a lightweight kitchen unit without a stone worktop and built-in appliances).¹⁶

BARLINEK S.A. shall not be held liable for any damage to panels caused by not following the above recommendations.

Ensure that correct tools and equipment are used for installation.¹⁷

Before installation, carefully measure the installation area and make sure that the width of the panels in the first and last row is not less than 1/3 of the width of the panel, and the length of the sections installed at the end of each row is above 200 mm.¹⁸

16

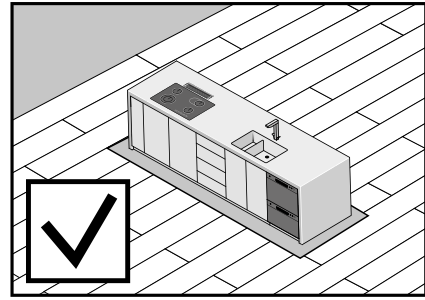

17

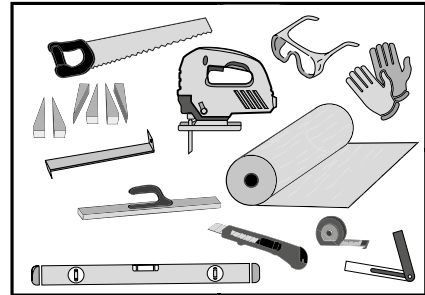

17

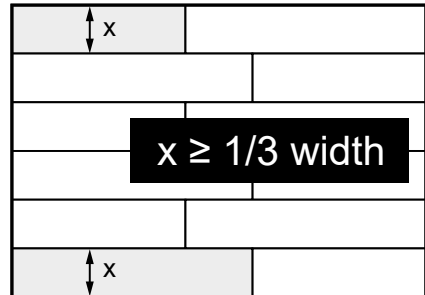

18

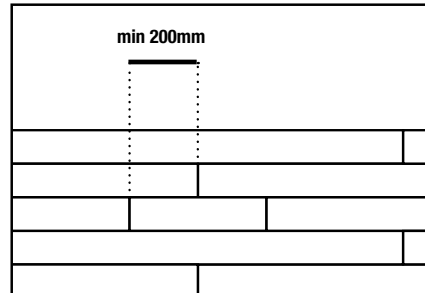

7. INSTALLATION

5G LOCK

Begin the installation from the left side of the starting wall. ¹⁹ The panel tongue of the starting row should face the wall and the lock groove should face the subsequent rows. Make sure you have set correct perimeter expansion gaps during this installation step (use wedges to make the width of the gaps equal). ²⁰

The expansion gap should be made along the perimeter of the room and around all other obstacles such as columns, stairs, ceramic tiles, etc.

Lay the next panel with its long edge along the wall and lock the short edge by pressing the panel vertically down. ²¹

Handsaw or electric saw can be used for cutting the panels. After cutting the last panel, remember to leave an expansion gap of at least 7 mm in width. If the cut-off panel piece is longer than 200 mm, it can be used for starting the installation of another flooring row. The distance between frontal joints in two adjacent rows of the floor should be at least 200 mm. ²²

When laying the following rows, insert the first panel at a 20° angle into the **LONGITUDINAL** groove of the panel lock of the previous row, then gently push the panel down to the floor. Insert the next panel in a similar manner, without pressing the element completely to the floor, then slide it gently over the lock of the short side of the previous panel and press the whole element gently to make the short joint. ²³

Use a non-rebound rubber mallet and a dedicated striking tool to close the joints if required. If necessary, use a pressure roller for final levelling of the joint edges. ²⁴

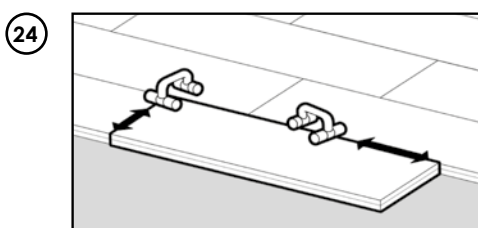
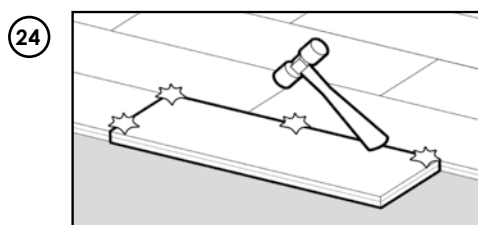
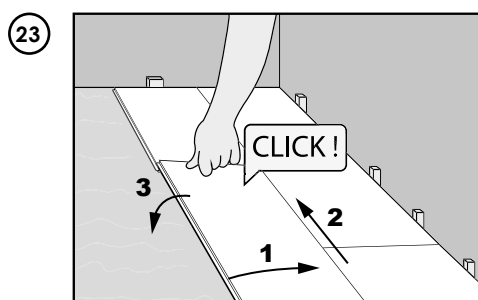
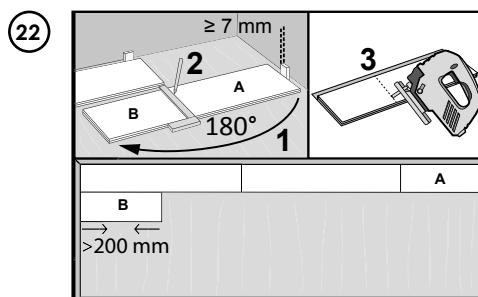
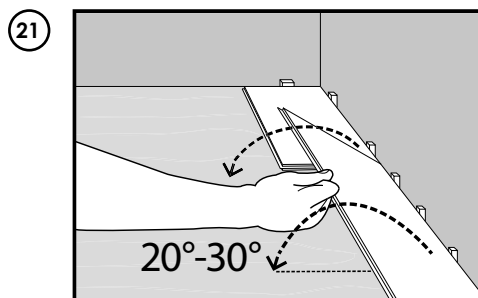
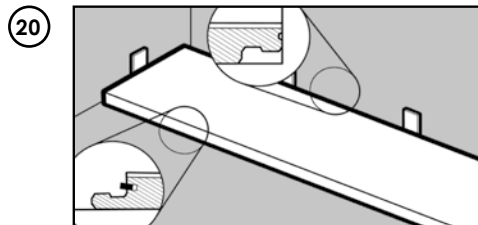
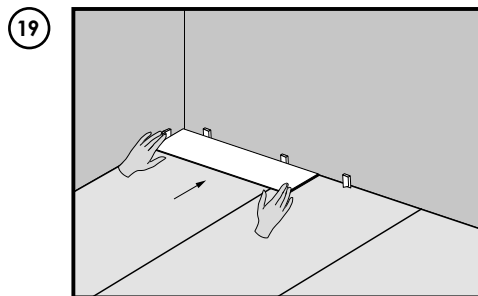

For the panels to be laid near the radiator tubes, draw the openings with a diameter larger by 20 mm. ²⁵

Cut the openings in the panel. Draw a line across the middle of the openings and use the saw to cut the panel. ²⁶

Bond the cut-off panel piece with construction adhesive. ²⁷

There is no need to make an expansion gap in the passage from one room to another. The expansion gap must be made at the walls and other elements permanently embedded into the building e.g. stairs, columns and other obstacles. ²⁸

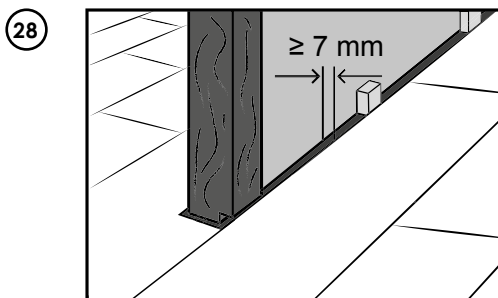
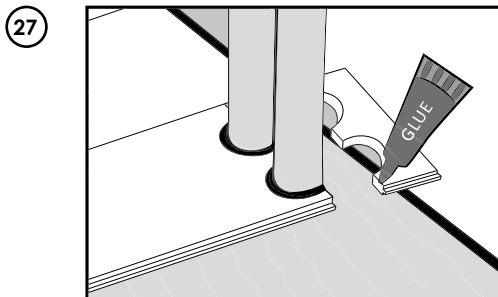
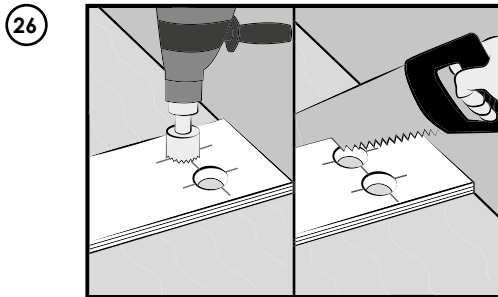
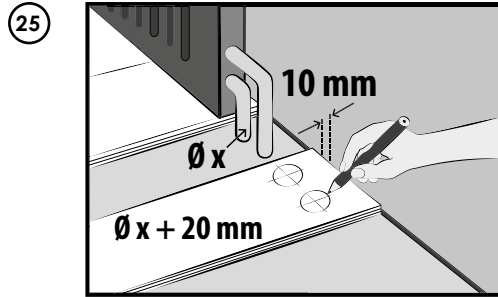

2G LOCK

Begin the installation from the left wall side and continue to the right. The longitudinal lock tongue of the starting row panels should face the wall and the lock groove should face the subsequent rows. Maintain the correct expansion gaps as described above.²⁹

Place the short edge of the next panel at an angle of approx. 20° to the first one and lay it down. The joined panels must be perfectly in line.³⁰

Handsaw or electric saw can be used for cutting the boards. After cutting the last panel, remember to leave an expansion gap of at least 7 mm in width. If the cut-off panel piece is longer than 200 mm, it can be used for starting the installation of another flooring row. The distance between frontal joints in two adjacent rows of the floor should be at least 200 mm.

The last panel in the first floor row can also be cut off with a sharp cutting knife, provided that the length of the cut-off section is about 300 mm. Cut the top layer several times and then break the panel by resting it on a straight edge.³¹

Tap the last board lightly with a metal pull bar to close possible gaps.³²

Place the panel in the second row of the floor at an angle of approx. 20° in the longitudinal lock of the first panel.³³

The second panel in a row is installed by joining shorter edges of the boards. Lift the first panel at an angle of approx. 20° (you can use support wedges), lift the second one at an angle of approx. 20° in relation to the first one; insert it in the short edge (1) and then lay down so that the board rests on the longitudinal lock of the first row (2). It is important to push the lifted board closer to the longitudinal lock leaving ca. 2 mm gap.³⁴

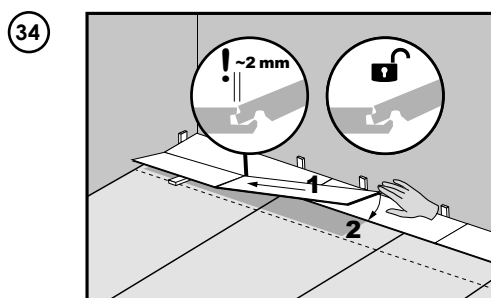
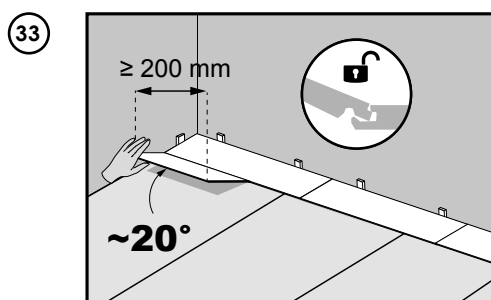
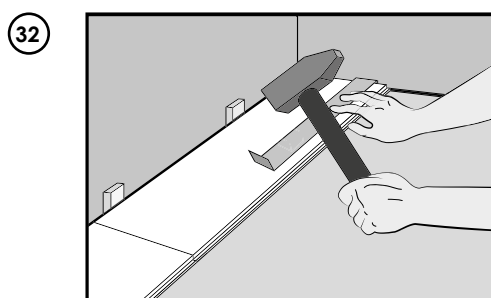
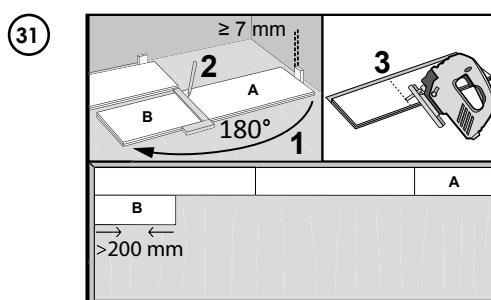
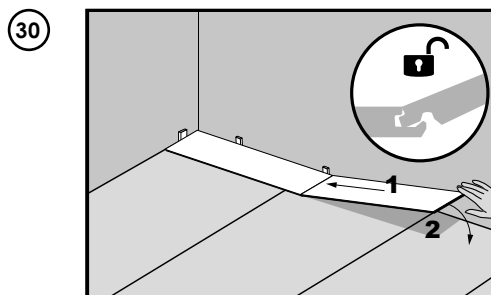
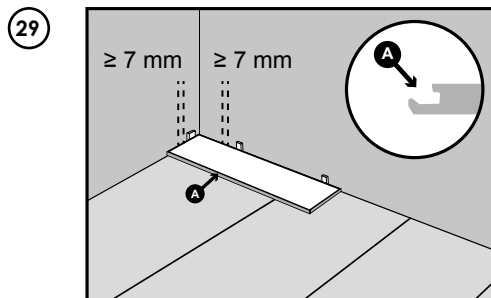

Leave ca. 2 mm gap at the longitudinal lock of the first row of the panels! Then gently tap the panel at the longitudinal lock. This installation is done with the panels lifted at an angle of about 20°. Then remove the wedges supporting the panels. Gently lay down the panels tapping them along the entire floor row (be careful not to damage the panel lock). The tapping block touches the lock external part. Do not tap on the wear layer. ³⁵

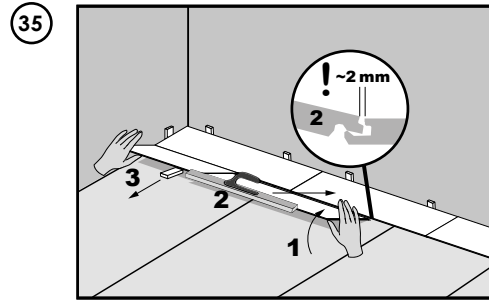

Use the metal pull bar to tap the last row of the boards. ³⁶

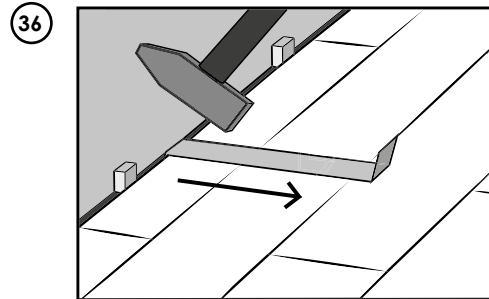

For the panels to be laid near the radiator tubes, draw the openings with a diameter larger by 20 mm. ³⁷

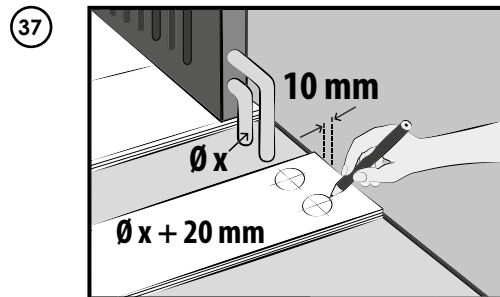

Cut the openings in the panel. Draw a line across the middle of the openings and use the saw to cut the panel. ³⁸

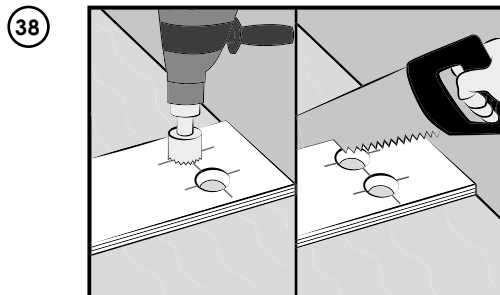

Bond the cut-off board piece with construction adhesive. ³⁹

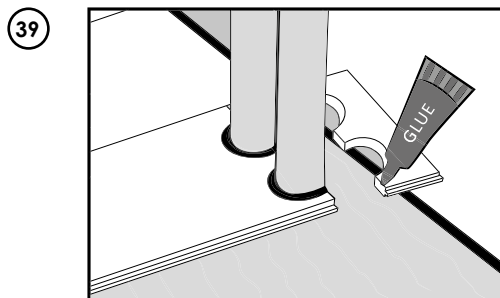

There is no need to make an expansion gap in the passage from one room to another. The expansion gap must be made at the walls and other elements permanently embedded into the building e.g. stairs, columns and other obstacles. ⁴⁰

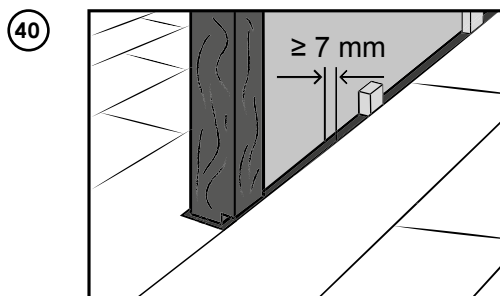

8. ACCESSORIES AND FINISHING

Once the installation is done, remove the wedges and fix skirting boards to the wall.

DO NOT USE any compound, silicone or acrylic putty to fill the expansion gaps.⁴¹

Contact your dealer or **BARLINEK S.A.**'s technical support for information on the accessories available

9. FIRST CLEANING AND STARTING TO USE

Before starting to use the floor, **BARLINEK S.A.** recommends vacuuming it thoroughly and washing the surface with a damp mop, using the Protektor Koncentrat product⁴²

To maintain **NEXT STEP LVT** in a satisfactory condition, **BARLINEK S.A.** recommends regular vacuuming and washing of the panel surface. In addition to that, depending on the intensity of use, the floor should be regularly cared for using appropriate technology and dedicated products. For details, please refer to the "Conditions for use and care for the Next Step vinyl floors" available at www.barlinek.com.

The panels should be protected as far as possible from prolonged exposure to intense sunlight.⁴³

The feet of furniture used on floor surfaces should be protected with special felt pads, which should be periodically replaced.⁴⁴

If the product is installed in an entrance area, next to the door leading directly to the outside, efficient cleaning mats are required.⁴⁵

Use chairs or other furniture with castors on plastic protective mats.⁴⁶

Do not use high-pressure washers or steam for cleaning the floor.⁴⁷

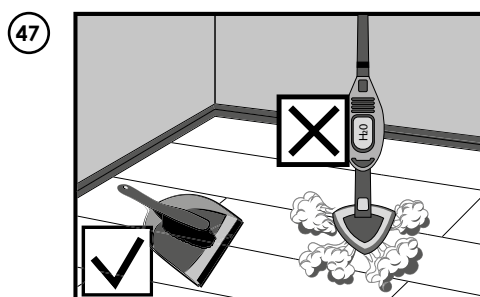
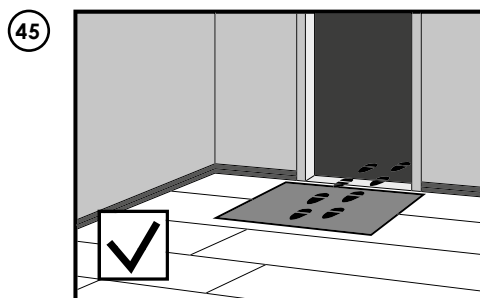
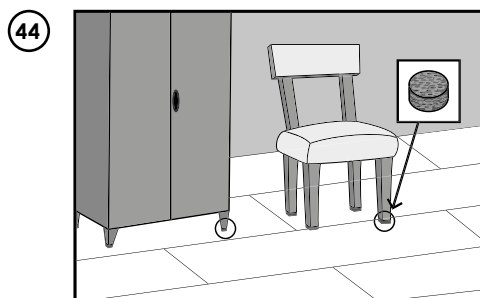
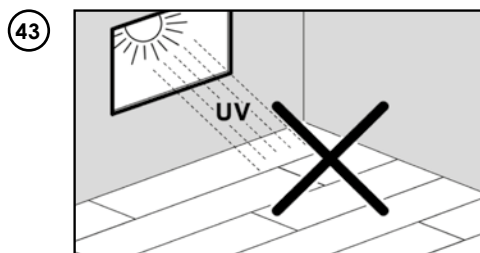
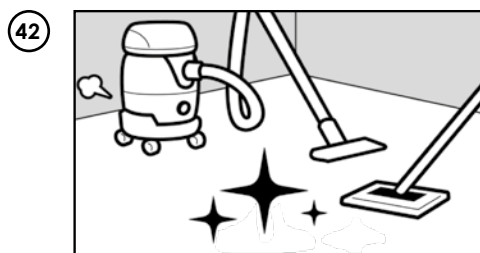
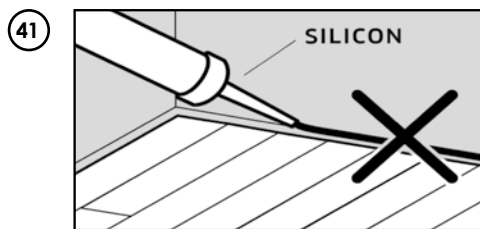

IMPORTANT

The "Conditions for use and care for the Next Step vinyl floors" and the "Warranty terms of the Next Step floors" are available at **[barlinek.com](https://www.barlinek.com)**.